

WHY CIFA



Truck Pumps
CARBOTECH Series



WHY CIFA



FIRST IN INTRODUCING CARBON FIBER IN CONSTRUCTION MACHINERY

Ahead of their times, innovating constantly the products. A commitment that, since the beginning, has seen us as key players, making the story of this industry. The introduction of carbon fiber in the construction of Carbotech series booms places itself in this journey, with the goal of improving performances of our equipments and quality of the job of those who use them every day in the job site.



READY FOR DELIVERY



MANUFACTURING FACILITIES



LEAN PRODUCTION



PLACING BOOMS
Available lengths to reach all distances: from 40 meters to 80 meters.



PUMPING UNITS
Two open loop types and three closed loop types according to the desired way of pumping.



CONTROL SYSTEMS
Designed and positioned to facilitate job and to speed-up all operations.



STABILIZATIONS
Different types of stabilization in order to guarantee a safe work in a small area.



SAFETY
Different systems to work and move the boom in all its configurations in total safety.

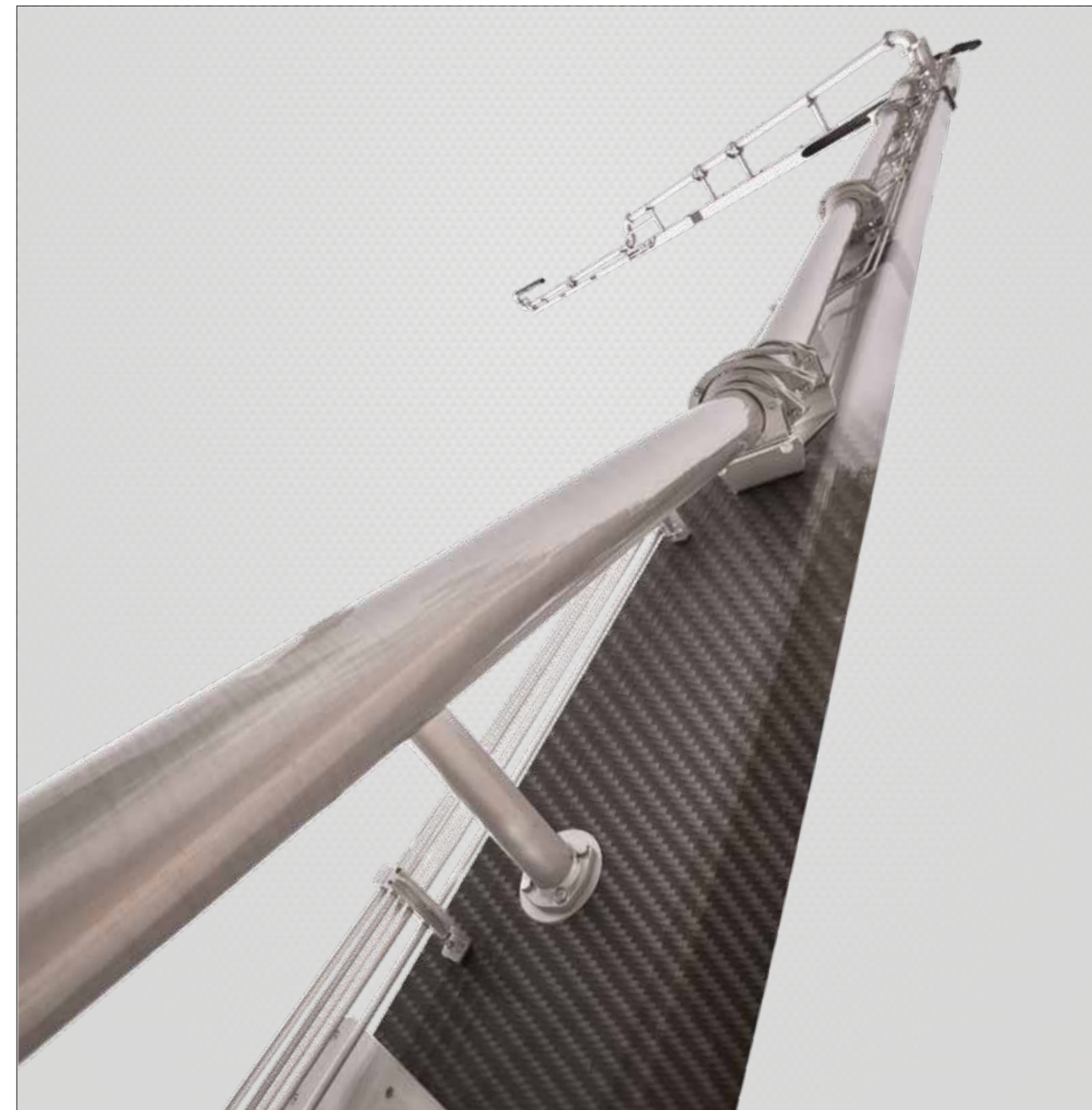

LEASING



Available in Italy, Russia, China, South Africa, Australia, USA

ITALIAN DESIGN



Main components of the CIFA truck pumps are Italian or German brand

MOUNTED ON ALL TRUCK BRANDS



CIFA truck pumps can be mounted on all truck brands. According to CIFA truck specifications documentation

TRAINING FOR OPERATORS



CARBOTECH SERIES: THE REVOLUTION IN CONCRETE DISTRIBUTION

In 2010 CIFA introduced the use of composite materials in the machinery construction industry, making a series of concrete distribution booms with this innovative technology. Thanks to the growing market demand, CIFA offers to the market a wider range of Carbotech Series, from 40 to 80 meters boom.



CARBOTECH

CIFA Carbotech Video



Lighter and, so, longer; but at the same time stronger and more resistant. CIFA Carbotech booms allow to obtain unparalleled results, overcoming inviolable limits, in terms of heights and lengths.

+20% Stronger

TO WITHSTAND THE HARDEST STRESSES
Composite materials offer higher resistance to strains and fatigue compared to steel.

-25% Weight

LIGHTER, ALSO IN TRANSFERS
To respect legal limits and at the same time to save fuel in transfers compared to traditional pumps of the same length.

+20% Length

LONGER, TO GET ANYWHERE
Greater boom length means less placings of the pump on the job site.

LIGHTNESS, LENGTH AND STRENGTH: BEYOND ANY LIMIT



PLACING BOOM

STRENGTH AND RELIABILITY:

The booms mounted on CIFA truck pumps combine both strength and reliability. Each section of the boom has been designed for maximum structural resistance and fatigue strength. All Carbotech booms are tested against fatigue at the TEC testing center, allowing us to certify the life of these components with a 5 years warranty.



VERSATILITY AND FLEXIBILITY:

The different configurations of the booms on CIFA truck pumps ensure the greatest operative versatility and enable to reach almost any part of the construction yard, even those accessible with the most difficulty. Complete working flexibility together with great working speed, allows the complete extension of the boom and its perfect and fast positioning.



RZ type

Ideal for 5 and 6 sections boom. It provides maximum flexibility by combining R+Z solutions.

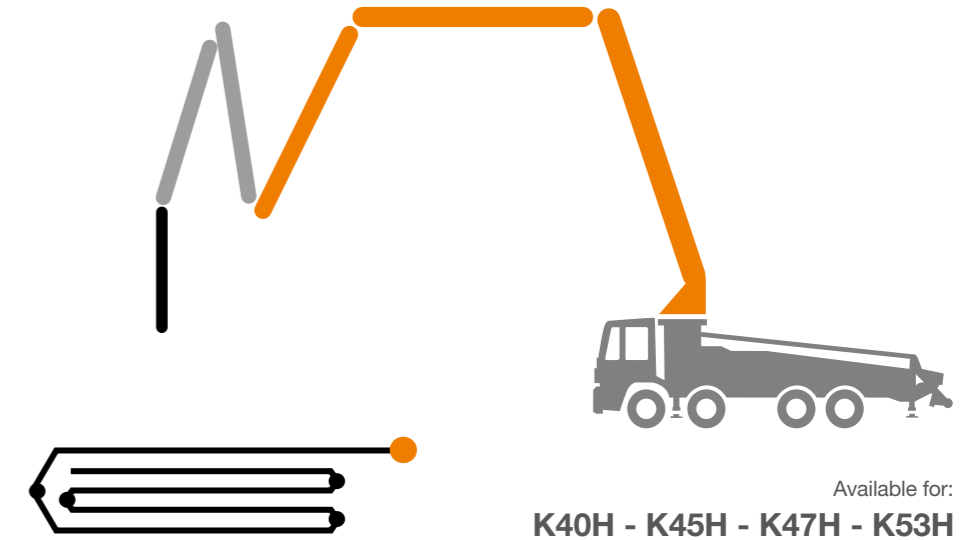

RRZ type

It provides maximum flexibility by combining R+Z solutions.

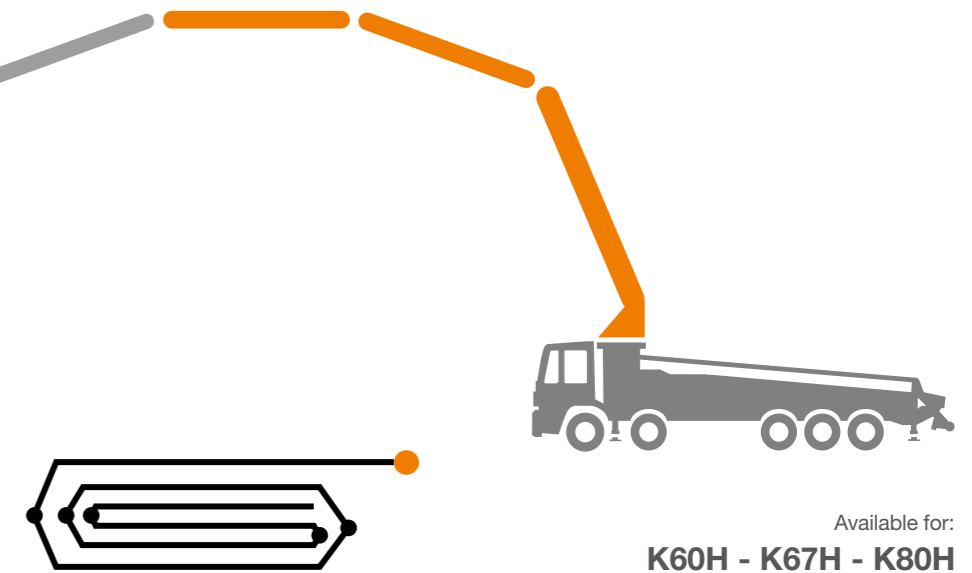

FOLDING SYSTEMS



Completely removable, the pumping unit ensures gentle, continuous and regular flow. This technology guarantees an extremely efficient system for pumping different types of concrete, with aggregates of all sizes, reducing the number of cycles per minute while maintaining the same flow rate, thus ensuring less wear and longer life.



PUMPING UNIT

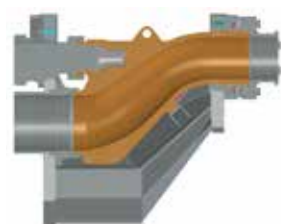

“S” VALVE:
The structure is made with varying thickness to achieve maximum resistance to wear even when using difficult types of concrete.



WEAR RING AND WEAR PLATE:
The ring and the plate are made of special anti wear material against abrasion and stress due to the concrete flow.



CIFA LONG LIFE PIPES MADE BY CIFA
CIFA truck pumps have long life pipes as standard equipment. LLT (Long Life Top) version available as option or as standard supply according to model.



CIFA truck pumps have the first bend outside the pumping unit in long life pipes as standard equipment.

CARBOTECH

Closed Loop: Electronic management



HP1608EC

Available for:
K40H - K45H - K47H

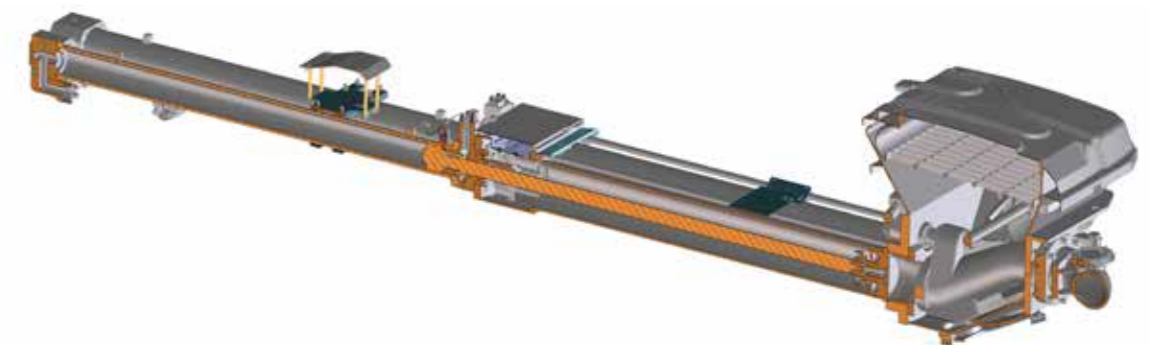

HP1808ECX

Available for:
K45H - K47H - K53H - K60H - K67H - K80H

PUMPING UNITS		HP1608EC	HP1808ECX
MAX. THEORETICAL OUTPUT	m ³ /h	160	180
MAX. PRESSURE ON CONCRETE	bar	80	83
MAX. NUMBERS OF CYCLES PER MIN.	n	31	27
CONCRETE CYLINDERS (DIAM. X STROKE)	mm	230x2100	260x2100
CONCRETE HOPPER CAPACITY	l	550	600
HYDRAULIC CIRCUIT	type	closed	closed



CONTROL SYSTEMS



BOOM PROPORTIONAL DISTRIBUTOR
Ergonomic hydraulic controls for boom.



REMOTE CONTROL
Comfortable and lightweight for boom control and the management of the main machine functions. Different models and brands available.

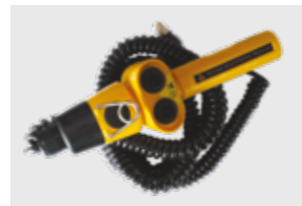

WIRED VIBRATOR AND HORN REMOTE
Convenient cable control dedicated to the mixer driver. It can be used from both sides of the hopper.



DETACHABLE ELECTRICAL SYSTEM
The electrical system can be detached for easy maintenance.



HYDRAULIC OUTRIGGERS CONTROL
Hydraulic controls on both sides of truck pump. The machine emergency stop is also positioned nearby.



REAR CONTROL PANEL
Control panel positioned on the rear side.

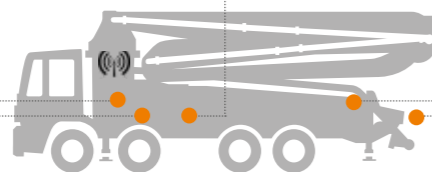

CARBOTECH

Smartronic®

Smartronic is the most advanced machine management system for truck-mounted pumps. It oversees every functionality providing a clear and user-friendly interface. It is available in the silver and gold versions as standard on Carbotech series according to the pump model. The gold version can be completed with the Smartronic advanced package delivering an additional set of features

SILVER



DISPLAY LCD 7"



PUMPING UNIT MANAGEMENT
Automatic hopper-grid vibration



DIAGNOSTICS
In case of fault, the operator is guided to understand what's the subpart involved and graphically guided to understand the issue



COUNTERS

GOLD

Standard for Carbotech series (excl. K40H)
Includes SILVER functions plus:

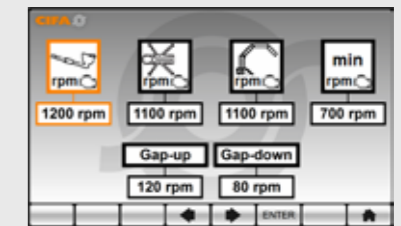

AUTO RPM
Fully adjustable automatic truck RPM management



RAMPS MANAGEMENT
Fully adjustable pumping ramps management



MBE Max Boom Extension

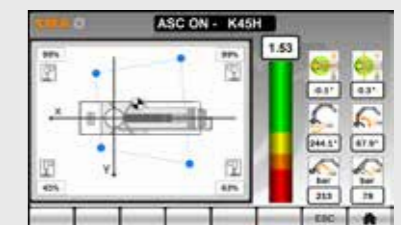

ASC Advanced Stability Control

ASC Advanced Stability Control

(complying EN 12001:2012)

The ASC system, included in SMARTRONIC GOLD, controls the stability of the truck-mounted pump in real time, in every short-rigging condition. The system is intelligent and maximizes the area reachable by the boom tip according to the actual outriggers configuration. When approaching the stability limit condition the boom is at first slowed down and then even stopped preventing a critical condition.

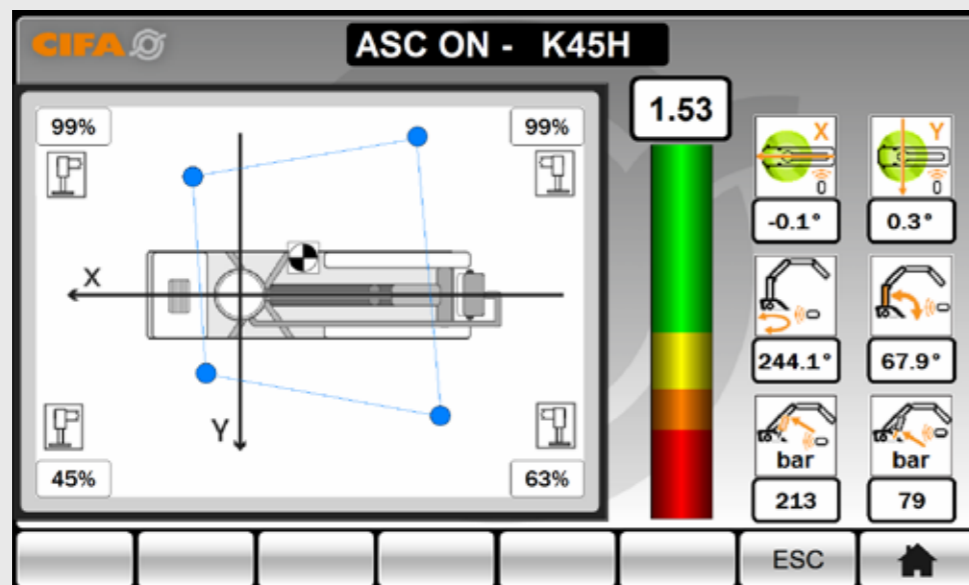

Max Boom Extension - MBE

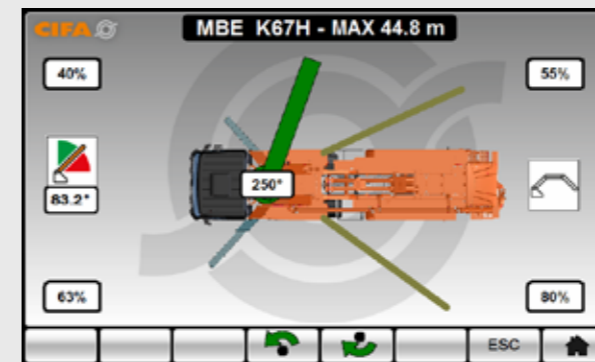

Max Boom Extension is part of the Smartronic GOLD features together with the Auto RPM and the Advanced Stability Control.

This function helps the operator to know the maximum distance reachable with the boom with a partial opening of the outriggers, before opening the boom

Smartronic Advanced (Add-on for Smartronic GOLD)

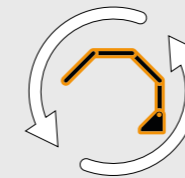

Automatic Boom Folding and Unfolding

The function allows to open and close the boom automatically using a dedicated command on the radio remote.

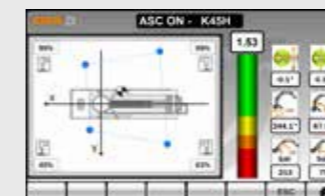

ASC 2.0

Gives the possibility to move some boom sections even when the limit of the safety coefficient is reached.



Boom Antibouncing System

The Anti-Bouncing function strongly reduces boom oscillations (up to -25%).



Radio remote control with display





STABILIZATION

The front stabilization is available in four design concepts: single horizontal, single, double and triple telescopic-X-style outriggers. The rear stabilization is available in three design concepts: fixed, single extension and swing-out. Each machine has its stabilization system according to the size of the boom.

Front: **Single telescopic X style**
Rear: **Swing-out**

Available for:
K40H

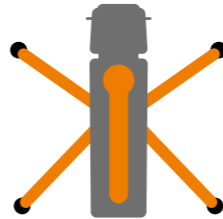

Front: **Double telescopic X style**
Rear: **Swing-out**

Available for:
K45H - K47H - K53H - K60H



Front: **Triple telescopic X style**
Rear: **Swing-out**

Available for:
K67H

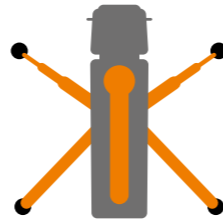

Front: **Swing-out + Double telescopic X style**
Rear: **Swing-out**

Available for:
K80H



All outriggers are designed to stabilize the machine in the right way in extraordinary tight spaces.

The sequences of the extension phase are quick in order to accelerate the stabilization.

Every Swing-out can be used as a tank; the capacity goes from 600 to 800 litres per each swing-out.

SAFETY



MECHANICAL LOCK FOR ALL OUTRIGGERS

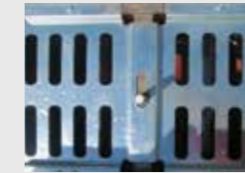

WATER BOX GRID PROTECTION



HOPPER GRID LIMIT SWITCH



PROTECTION FOR S-VALVE CYLINDERS



BOOM ROTATION LIMIT SWITCH



SUPPORT PLATES HOLDER



OUTPUT BEND LOCKING SYSTEM

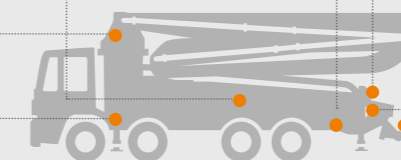

OPTIONS

LIGHTS HOLDER UNDER THE HOPPER



FOLDING BUMPER BAR WITH INTEGRATED LIGHTS



TWO DIFFERENT TYPES OF SHUT OFF VALVE AS OPTION

The shut-off valve stops immediately the flow of the concrete.



Shut Off valve on endhose



Shut Off valve in pipeline



Activation by remote control

High pressure water pump



Air compressor for pipeline cleaning



Remote machine monitoring



Rear camera



List of other components available on demand

Wood stocks holders



Ladder to fuel tank access



Light on boom



DATA SHEET

CARBOTECH



CARBOTECH K40H

PLACING BOOM	B5HRZ 40/36
PUMPING UNIT	160 m ³ /h 80 bar
DRIVEN BY	PTO OR GEAR BOX
CHASSIS	3 AXLES



CARBOTECH K45H

PLACING BOOM	B5HRZ 45/41
PUMPING UNIT	160 m ³ /h 80 bar
	180 m ³ /h 83 bar
DRIVEN BY	PTO OR GEAR BOX
CHASSIS	4 AXLES



CARBOTECH K47H

PLACING BOOM	B5HRZ 47/43
PUMPING UNIT	160 m ³ /h 80 bar
	180 m ³ /h 83 bar
DRIVEN BY	PTO OR GEAR BOX
CHASSIS	4 AXLES



CARBOTECH K53H

PLACING BOOM	B5HRZ 53/49
PUMPING UNIT	180 m ³ /h 83 bar
DRIVEN BY	PTO OR GEAR BOX
CHASSIS	4-5 AXLES



CARBOTECH K60H

PLACING BOOM	B6HRRZ 60/56
PUMPING UNIT	180 m ³ /h 83 bar
DRIVEN BY	PTO OR GEAR BOX
CHASSIS	5 AXLES



CARBOTECH K67H

PLACING BOOM	B7HRR 67/63
PUMPING UNIT	180 m ³ /h 83 bar
DRIVEN BY	PTO OR GEAR BOX
CHASSIS	6 AXLES



CARBOTECH K80H

PLACING BOOM	B7HRRZ 80/76
PUMPING UNIT	180 m ³ /h 83 bar
DRIVEN BY	PTO OR GEAR BOX
CHASSIS	7 AXLES

Find more info on trucks configuration at www.cifa.com/documentation



K47H - ITALY



K45H - HOLLAND



K60H - FRANCE



K67H - FINLAND



K53H - GERMANY



K40H - BELGIUM



K80H - POLAND

JOB SITES



Discover more at www.cifa.com

Distributor



CIFA S.p.A.

Via Stati Uniti d'America, 26
20030 Senago (Milano) - Italy

tel. +39.02.990131

fax. +39.02.9981157

sales@cifa.com

www.cifa.com

